

---

*Comfort-Aire*®

**Century**®



---

REPLACEMENT PARTS LIST

**Low Temperature Mini-Split  
Indoor Ducted Unit**

B-VMH18DU-1

# EXPLODED VIEW

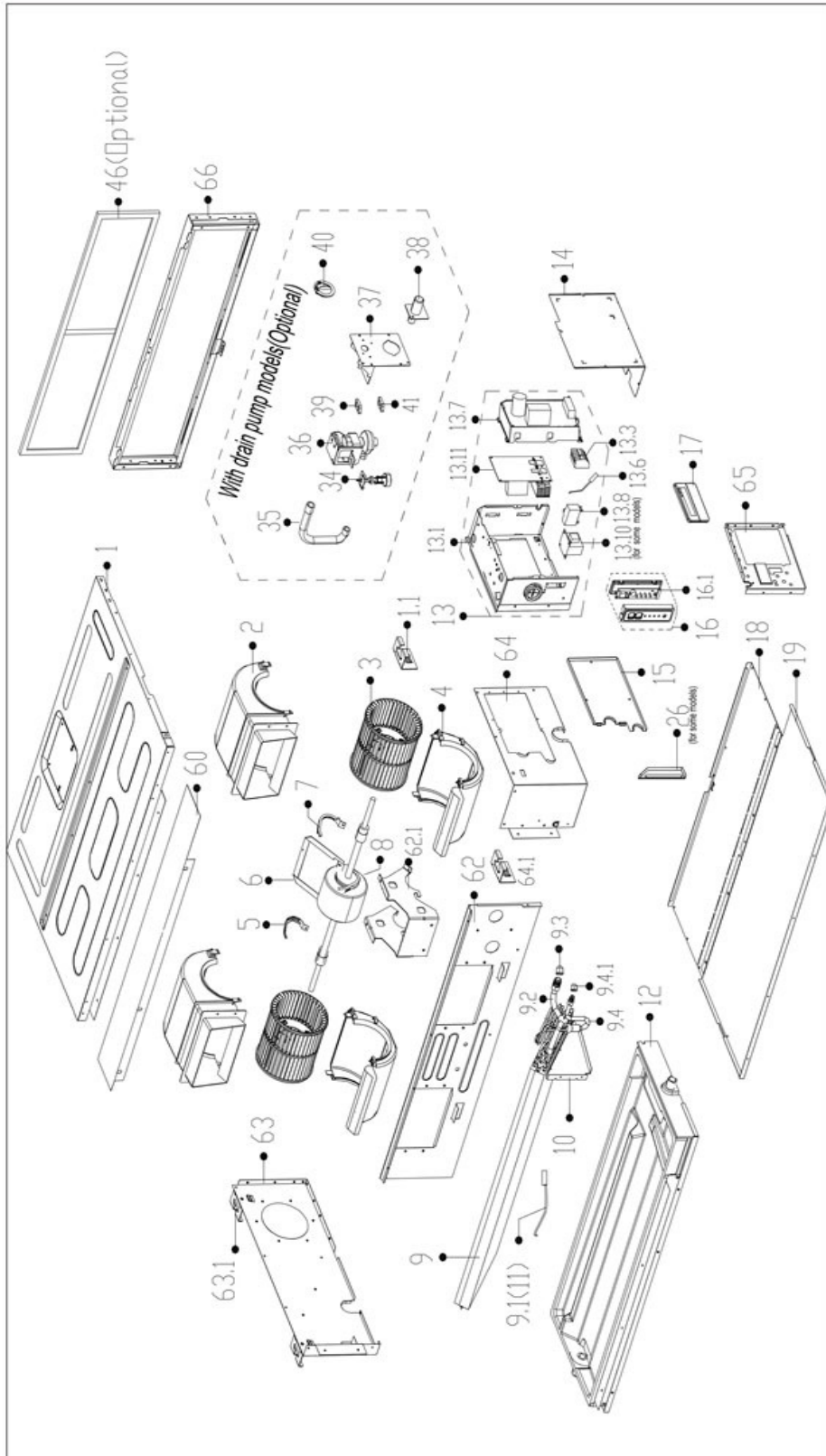

## REPLACEMENT PARTS

Location	Part Name	Quantity	Part No.
1	Chassis assembly	1	12223000007007
2	top volute	2	12123000000801
3	centrifuge fan	2	12100103000584
4	bottom volute	2	12123000000802
5	Fan motor clamp (left)	1	12222500000253
6	Fan motor fixing bracket	1	12223000000537
7	Fan motor clamp (right)	1	12222500000255
8	Brushless DC Motor	1	11002015002521
9	Evaporator Assembly	1	15823000003881
9.1	Pipe Temperature Sensor	1	11201007000136
9.2	Evaporator outlet pipe subassembly	1	15123000008692
9.3	Copper nut	1	15500406000012
9.4	Evaporator inlet pipe subassembly	1	15123000010347
10	Evaporator right support board subassembly	1	12223000006629
12	Water collector assembly	1	12823000000190
13	E-Parts Box assembly	1	17223000004456
13.1	Electronic control box	1	12223000006630
13.3	Wire joint	1	17400401000075
13.6	Room Temperature Sensor	1	11201007000283
13.7	Main control board subassembly	1	17123000003492
13.10	Reactor	1	17400306000070
13.11	Inverter module subassembly	1	17122000030569
14	Cover of electronic control box	1	12223000006627
15	Pipe clamp board subassembly	1	12223000008575
16	Duct display board subassembly	1	17223000000003
16.1	Duct display board subassembly	1	17123000002712
17	Wired controller	1	17317100001195
18	rear cover	1	12223000006632
19	Top cover assembly	1	12223000006636
46	Air filter	1	12123000A00301
60	Rear beam subassembly	1	12223000008573
62	Middle beam subassembly	1	12223000008576
63	Left clapboard subassembly	1	12223000008574
64	Right clapboard subassembly	1	12223000008572
65	Right side plate	1	12223000008577
66	Right clapboard subassembly	1	12223000A03117

---

Due to ongoing product improvements, specifications and dimensions are subject to change and correction without notice or incurring obligations. Determining the application and suitability for use of any product is the responsibility of the installer. Additionally, the installer is responsible for verifying dimensional data on the actual product prior to beginning any installation preparations.

Incentive and rebate programs have precise requirements as to product performance and certification. All products meet applicable regulations in effect on date of manufacture; however, certifications are not necessarily granted for the life of a product. Therefore, it is the responsibility of the applicant to determine whether a specific model qualifies for these incentive/rebate programs.

*Comfort-Cire*®  **Century**®

1900 Wellworth Ave., Jackson, MI 49203 • Ph. 517-787-2100 • [www.marsdelivers.com](http://www.marsdelivers.com)

