Comfort-Cire®

Century®

MARS®
Delivering Confidence

PARTS LIST

**Horizontal/Side Discharge
Condensing Units**

CMA30SD-1

EXPLODED VIEW

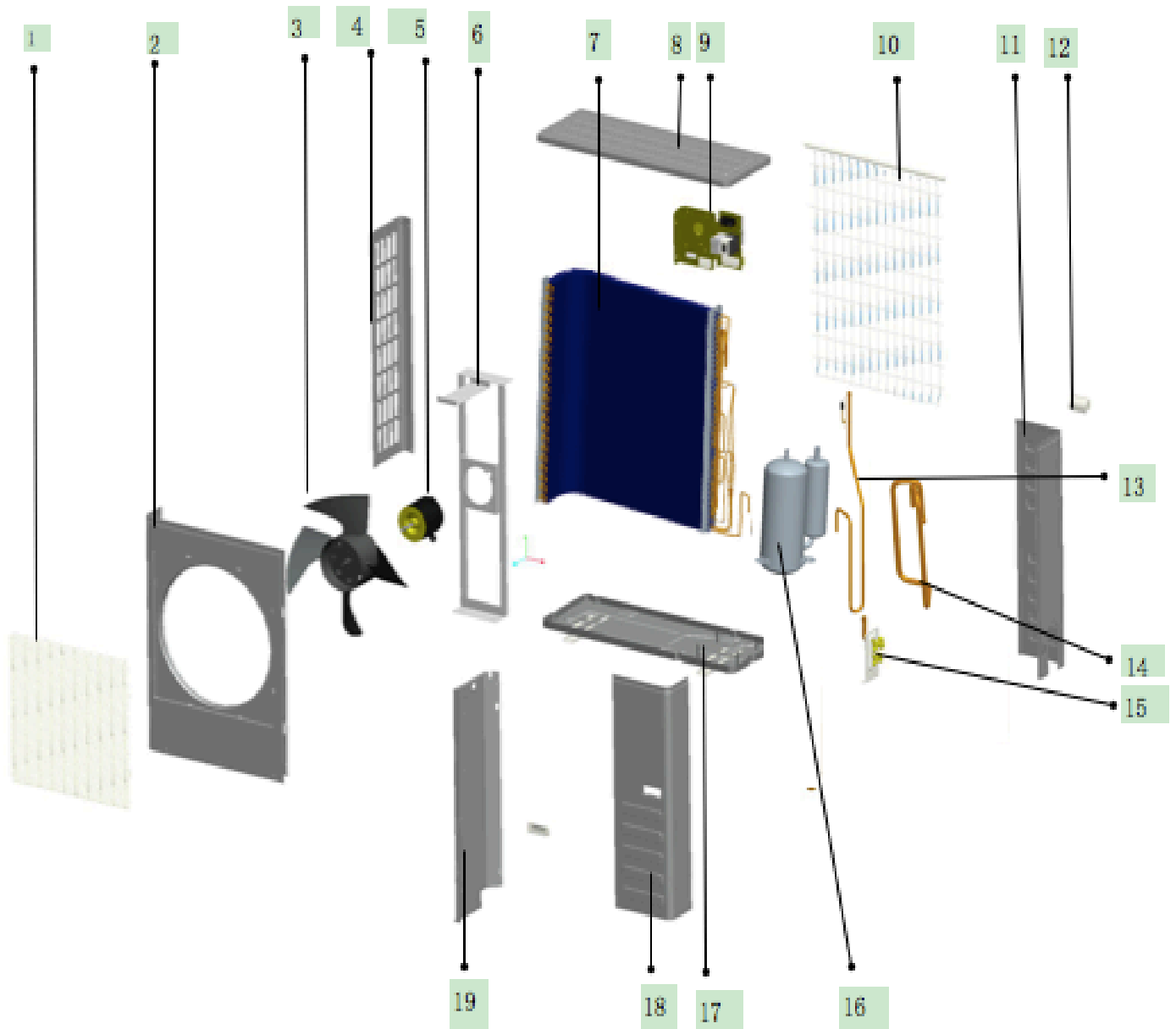

REPLACEMENT PARTS

Location	Part Name	Part No.
1	Net cover	802900800074
2	Panel	801219900130
3	Propeller fan	801100300014
4	Left separating board	801219900116
5	Outdoor motor(YDK-200-6C)	802400400444
6	Support for motor	801219900108
7	Condenser parts	801528490001
8	Top cover board parts	801219900137
9	The electric control parts	803328490001
9.1	Fan motor capacitor	802401100083
9.2	AC contactor	802300100251
9.3	Terminal	802401800085
9.4	Outdoor PCB board assy	801233400046
10	Back mesh	802900800008
11	Right separating board	801219900121
12	Pull handle	801119900037
13	Exhaust pipe assy assy	801628490011
13.1	Exhaust pipe assy	801628490012
13.2	Exhaust pipe assy	801628490013
13.3	High-pressure switch	802300900041
13.4	Instalation tube for probe	801602600197
14	Weld assembly for Air suction pipe(B)	801629200195
14.1	Air suction pipe (B)of compressor	801628490009
14.2	Air suction pipe (B)of compressor	801628490010
15	Base borad for valve assy	801229200039
15.1	Base borad for valve	801219900097
15.2	Stop valve	801619900126
15.3	Stop valve	801629000001
16	Compressor	801401100050
17	Chassis	8K1228490001
18	Maintenance panel	801219900143
19	Median septum	801219900279
Not Shown	Instalation board for E-parts	801219900153
Not Shown	Pressure switch	802300900041
Not Shown	Compressor capacitor	802401000058
Not Shown	Fan motor capacitor	802401100083

Due to ongoing product improvements, specifications and dimensions are subject to change and correction without notice or incurring obligations. Determining the application and suitability for use of any product is the responsibility of the installer. Additionally, the installer is responsible for verifying dimensional data on the actual product prior to beginning any installation preparations.

Incentive and rebate programs have precise requirements as to product performance and certification. All products meet applicable regulations in effect on date of manufacture; however, certifications are not necessarily granted for the life of a product. Therefore, it is the responsibility of the applicant to determine whether a specific model qualifies for these incentive/rebate programs.

Comfort-Aire®

1900 Wellworth Ave., Jackson, MI 49203 • Ph. 517-787-2100 • www.marsdelivers.com

