



1900 Wellworth Ave. • Jackson, MI 49203  
517-787-2100

# Submittal Data

CMA36SD-1

Project Name:	
Location:	
Engineer:	
Submitted to:	
Submitted by:	
Reference:	

Approval:	
Date:	
Construction:	
Unit #:	
Drawing #:	

### Performance Data

Power supply Ph-V-Hz 208/230V~ 60Hz, 1Ph

### Cooling

Capacity	Btu/h	34400
Total Load	A	15.5
EER	Btu/w	11.4
SEER	Btu/w	13
MIN. CIRCUIT AMPACITY	A	19
MAX.FUSE	A	30

### Compressor Electrical

Model	AUH307RN-C9EUC
Type	ROTARY
Brand	HIGHLY
Capacity	Btu/h 30776(at 1150V)
Input	W 3005 (at 115V)
Rated current(RLA)	A 13.4(at 115V)
Coil Treatment	Silver



### Min. Outdoor Ambient Temperature

Outdoor(cooling) °F 65

### Fan Motor

Model	YDK100-6D / YDK100-6D
Brand	KAIBANG
Input	W 220/220
Capacitor	uF 5/5
Speed	r/min 830/830

### System Operational Data

Design pressure	PSIG	540/300
Refrigerant oil		R410A/4000g
Oil charge	oz	40.58
Refrigerant type/charge	oz	HAF68D1C or equivalent
Liquid side/ Vapor side	in	3/8-3/4
Max. length	ft	65.6
Max. height difference	ft	32.8

### Air Flow & Noise Level

Outdoor air flow	CFM	4120
Outdoor noise level	dB(A)	60

### Dimensional Data

		Dimension(W*D*H)	inch	35.9x15.75x52.36
Thermostat type	Standard 24v Control	Packing (W*D*H)	inch	37.95x15.83x56.9
Connection wiring	18ga 2 Conductor	Net/Gross weight	lbs.	185/207.2

# CMA36SD-1

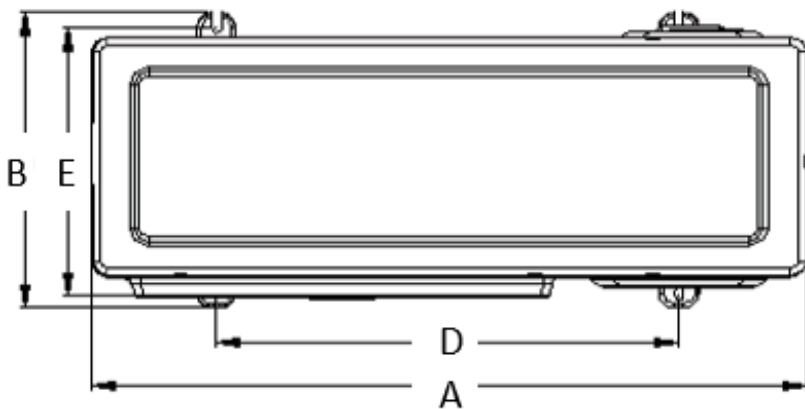
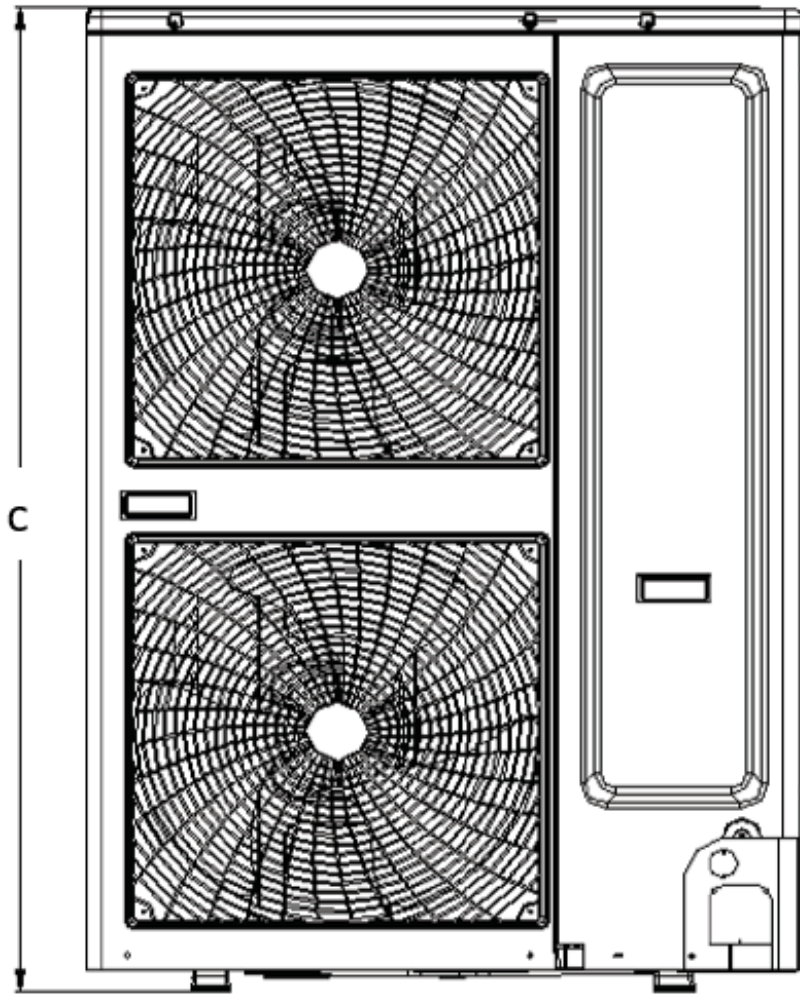

## Accessories

83907	Surge Protection
83916	Disconnect with internal surge
83335	60 amp Unfused Disconnect
93642	Wall Mount Bracket
93540	Condenser Pad

## Dimensions

Model	CMA36SD-1
A	35.9"
B	15.7"
C	52.4"
D	23"
E	14.2"